

# touchDock

Premium Motorized In-Wall Docking Station for iPad mini, 10.2", 10.9", 11" & 12.9"



intelligence. on.



## Our Masterpiece

touchDock is iRoom's flagship docking station, made entirely with scratch-resistant tempered glass and features the latest technologies iRoom has been implementing in its docking solutions. touchDock represents everything iRoom's premium docking solutions stand for:

- Available for **all current iPads**.
- **Code-protected, motorized** removal of the iPad when it's needed for mobile use.
- Flexible **flush-mount** in-wall installation, **horizontally or vertically**.
- Built-in control processor for **AV control** independent of the iPad.
- Built-in **sensor package** for room temperature, humidity, brightness, and air quality.
- Beautiful piece of craftsmanship with high-quality **scratch-resistant tempered** glass.



## FEATURES:

### Motorized Removal of the iPad 1

Built-in motor swings iPad out for hassle free removal

### High Quality Tempered & Scratch-Proof Glass 2

Both enclosure and front plate are made with black or white glass

### Horizontal or Vertical Flush Mount Installation 3

Installation Box included in delivery

### Smart Home / Smart Business Integration 4

Control Processor and Touch Keypad for stand-alone or 3rd party control

### Compatible with Professional Control Systems

Crestron, AMX, Control4, EnOcean, Gira HomeServer and many more

### Available in Black or White

Matches the iPad's front face

### Hands-Free Unlocking

Of the iPad Screen via Proximity Sensor

### Room Environmental Monitoring

Sensors for Room Temperature, Humidity, Light, and Air Quality

### Smart Battery Management 5

Extends the iPad Battery Life

### Antitheft Protection 6

Of the iPad with code-protected iPad Removal

### Powered by PoE+ or 100-240 V

Only one Cat Cable for Power and Control Communication

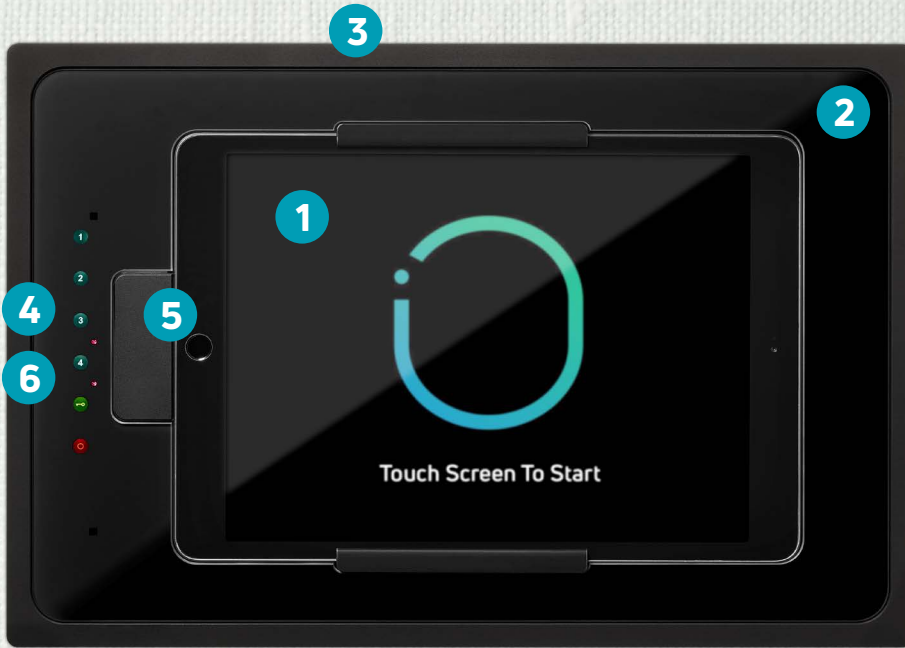
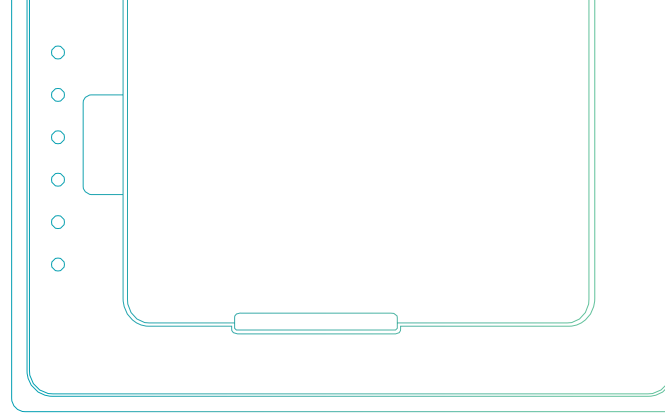

### Installation Video



[www.tinyurl.com/touchdock](http://www.tinyurl.com/touchdock)

iPad Compatibility	touchDock-mini	touchDock-mini-USB-C	touchDock-iPad10	touchDock-USB-C-iPad11	touchDock-USB-C-iPad12.9
iPad mini Gen 4 (2015)	•				
iPad mini Gen 5 (2019)	•				
iPad mini Gen 6 (2021)		•			
iPad 10.2" Gen 7 (2019)			•		
iPad 10.2" Gen 8 (2020)			•		
iPad Air 10.5" Gen 3 (2019)			•		
iPad Air 10.9" Gen 4 (2020)				•	
iPad Air 10.9" Gen 5 (2022)				•	
iPad Pro 11" Gen 1 (2018)				•	
iPad Pro 11" Gen 2 (2020)				•	
iPad Pro 11" Gen 3 (2021)				•	
iPad Pro 12.9" Gen 3 (2018)					•
iPad Pro 12.9" Gen 4 (2020)					•
iPad Pro 12.9" Gen 5 (2021)					•



## Specifications

Type	touchDock-mini	touchDock-mini-USB-C	touchDock-iPad10	touchDock-USB-C-iPad11	touchDock-USB-C-iPad12.9
<b>Outside Dimensions (WxHxD)</b>	290 x 205 x 80mm 11.4" x 8.1" x 3.2"		372 x 247 x 78mm 14.6" x 9.7" x 3.1"	372 x 247 x 78mm 14.6" x 9.7" x 3.1"	405 x 285 x 88mm 15.9" x 10.6" x 3.5"
<b>Cut-Out Dimensions (WxHxD)</b>	275 x 190 x 80mm 10.8" x 7.5" x 3.2"		357 x 232 x 78mm 14.1" x 9.2" x 3.1"	357 x 232 x 78mm 14.1" x 9.2" x 3.1"	393 x 270 x 88mm 15.5" x 10.7" x 3.5"
<b>Power Options</b>	PoE+ (IEEE 802.3at) 30 Watts Power Output or 100 - 240 V AC				
<b>iPad Charging Connector</b>	Lightning	USB-C	Lightning	USB-C	USB-C
<b>LAN</b>	10 Mbps				
<b>Communication</b>	TCP/IP, Status & Control				
<b>Functionality</b>	Store and Charge the iPad; AV & HVAC Control, Environment Monitoring via Sensors for Room Temperature, Humidity, Light Level and Air Quality*				
<b>Intelligent Glass Bezel</b>	6 touch buttons (with customizable icons) / 1 motion sensor				
<b>Audio output</b>	3,5 mm audio jack analog stereo / adjustable Line-Out				
<b>USB Port</b>	USB-A 5V/1A max. for USB accessories				
<b>Back Box</b>	Included				
<b>Operating Temperature</b>	0 - 35°C or 32 - 95°F				
<b>Operating Humidity</b>	20% - 90% RH non-condensing				
<b>Weight</b>	4,0kg / 8.8lbs		3,6kg / 7.9lbs	3,6kg / 7.9lbs	4,2kg / 9.3lbs

\* available in Q1/2023

