

THE HOME OF INNOVATION.

Eltako



© adobe.stock.com

THE PERFECT PLACE FOR THE IPAD.

THE PREMIUM IPAD DOCKING STATION FOR ANY SMART BUILDING

With the Eltako docking stations, the iPad becomes a control center that combines comfort with elegant design.

Eltako docking stations provide the perfect accompaniment for the seamless connection to the range of Eltako professional smart building products. In addition to your everyday apps, the iPad can be used with one of our controllers to visualise and control the areas of light, heating, shading and security



www.eltako.com



InWall-10-sz



OnWall-al



Manuals and documents in further languages:
<http://eltako.com/redirect/OnWall>



Manuals and documents in further languages:
<http://eltako.com/redirect/InWall-10-sz>



Front connection USB-C

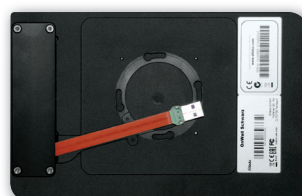

Back connection USB-A



Manuals and documents in further languages:
http://eltako.com/redirect/Austausch-Set_Lightning

OnWall-



Universal wall docking station with charging function for permanent horizontal installation of an Apple iPad with height-adjustable Lightning or USB-C connector. Removal possible at any time. Surface mounting via a flush-mounted electronics box. Milled from a block of aluminium. External power supply 100-240 V AC to USB included. Dimensions: 140,0 x 220,0 x 18,0 mm.

OnWall-al	Universal wall docking station for all Lightning iPads, with charging function, natural aluminium	Art. No. 30000001	357,80 €/pc.
OnWall-sz	Universal wall docking station for all Lightning iPads, with charging function, black anodized aluminium	Art. No. 30000002	357,80 €/pc.
OnWall/C-al	Universal wall docking station for all USB-C iPads, with charging function, natural aluminium	Art. No. 30000043	388,00 €/pc.
OnWall/C-sz	Universal wall docking station for all USB-C iPads, with charging function, black anodized aluminium	Art. No. 30000044	388,00 €/pc.

InWall-10



In-wall docking station with charging function for permanent vertical or horizontal installation (lock: pre-installed) of an Apple iPad 10,2". In-wall installation box. Aluminium frame and glass cover in black. The glass cover has mini openings for microphone and loudspeaker for use as an intercom system. External power supply 110-240 V AC to USB included. Dimensions: 226,0 x 315,0 x 78,0 mm, flush-mounted dimensions: 215,0 x 305,0 x 78,0 mm.

InWall-10-sz	In-wall docking station for iPads 10,2" with charging function, black anodized aluminium with black glass cover	Art. No. 30000003	382,70 €/pc.
---------------------	---	--------------------------	---------------------

Exchange set lightning on USB-C



USB-C cable with USB-A connector for exchanging lightning to USB-C for OnWall.

Exchange set lightning on USB-C	USB-C cable for exchanging lightning on USB-C for OnWall	Art. No. 30000007	112,30 €/pc.
--	--	--------------------------	---------------------

SALES MANAGER UK
STEPHEN PAYNE

+ 44 7810 094 384
stephen.payne@eltako.com