

IMPULSE SWITCHES WITH MONOSTABLE RELAY 10 A/250 V AC

OVERVIEW

Type	Switching type	Control voltage	Current consumption	Nominal switching current/voltage	Pushbutton type	Advantages and application
IFE12-10TS	Off-switch	12 V AC	5 mA	10 A/250 V AC	Without glow lamp	Impulse switch with 1 NO contact
IFES12-20TS	Impulse multi-circuit switch	12 V AC	5 mA	10 A/250 V AC	Without glow lamp	Multicircuit switch sequence 0/1/2/1+2/0
IFED12-20	Double off-switch	12 V AC	5 mA	10 A/250 V AC	Without glow lamp	Two separately controllable remote switch in one device; space-saving and well suited for new distributions



Mounting plate HPI

IFE..

Impulse switches with monostable relay 10 A/250 V AC

No annoying switching noises.
 For DIN rail and screw fastening.
 100% duty cycle.
 Increased insensitivity to unsafe contact with the button.
 Minimal power consumption.
 According to DIN VDE 0637 and EMC directive.
 Shock protected.

Dimension drawing in mm



Wiring diagram

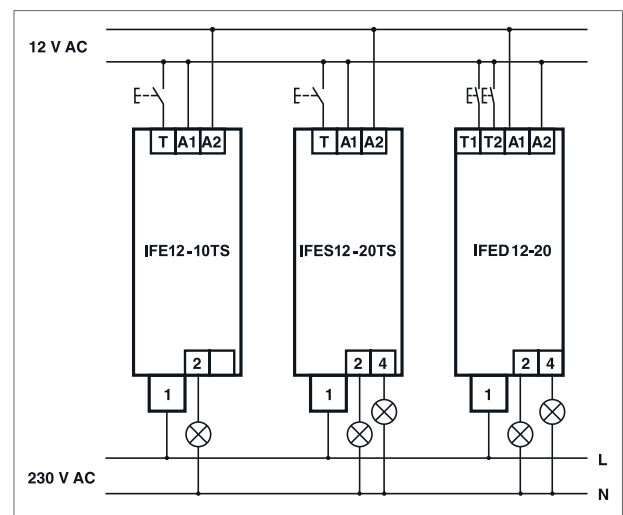

Max. fuse 10 A

Note: the buttons must be connected to T and optionally to A1 or A2. The remote switches with monostable relay are not suitable for operation with illuminated buttons.

IFE12-10TS	1 NO contact 10 A	No longer available
IFES12-20TS	1+1 NO contact 10 A	No longer available
IFED12-20	2x1 NO contacts 10 A	No longer available
HPI	Mounting plate with screws	No longer available

Technical data page 11-17.

Recommended retail prices excluding VAT.

IMPULSE SWITCHES WITH BISTABLE RELAY 10 A/250 V AC

OVERVIEW

Type	Switching type	Control voltage	Current consumption	Nominal switching current/voltage	Pushbutton type	Advantages and application
IFE12-10.11	Off-switch	12 V AC	1 mA	10 A/250 V AC	With or without glow lamp ¹⁾	Use with illuminated buttons: The button lighting is always on.
IFE12-20.13	Double off-switch	12 V AC	1 mA	10 A/250 V AC	without glow lamp	two separately controllable remote switch in one device

¹⁾ Suitable for all illuminated button types up to a maximum glow lamp current of 50 mA.



Mounting plate HP1

IFE..

Impulse switches with bistable relay 10 A/250 V AC

Dimension drawing in mm

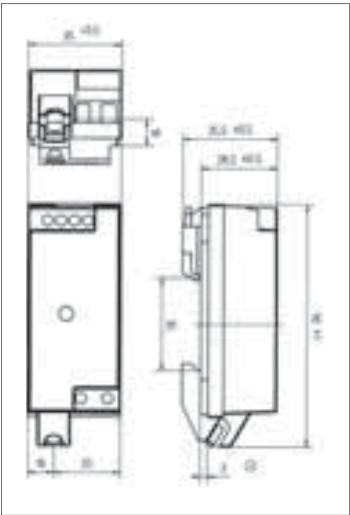

IFE12-10.11

For illuminated and non-illuminated buttons, button lighting always on.

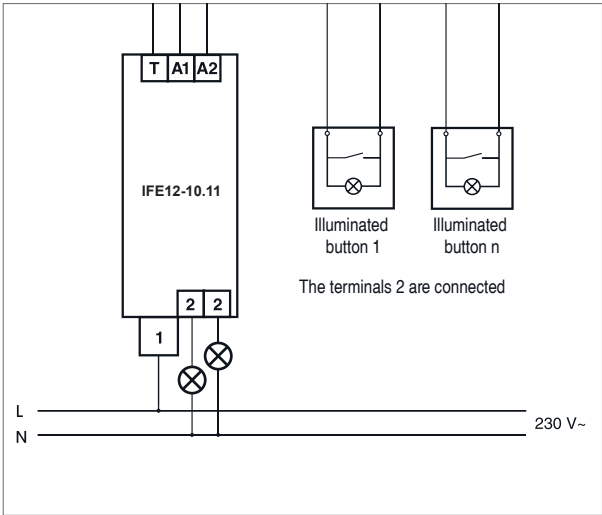

IFE12-10.11	1 NO contact 10 A	No longer available
IFE12-20.13	2x1 NO contacts 10 A	No longer available
HP1	Mounting plate with screws	No longer available

Technical data page 11-17.