



30 000 398 - 2

Position switch FPE-1

Wireless sensor with energy generator



Temperature at mounting location:
-20°C up to +50°C.
Storage temperature: -25°C up to +70°C.
Relative humidity:
annual average value <75%.

Wireless position switch with energy generator 48 x 32 x 11.5 mm. Generates the power for wireless telegrams itself when the lever is pressed, therefore there is no battery, no connecting wire and no standby loss.

When pressing the operating lever a wireless telegram Data (hex) 0x10 is sent and when releasing Data (hex) 0x00 is sent, like a wireless pushbutton.

For more than 100,000 switching cycles, replaceable compression spring.

Fastening by screws. Adhesive fastening is not recommended due to the high restoring force.

The 48 mm long lever can be shorted to 27 mm by removing part of it.

The wireless module integrated in the wireless position switch can be taught-in encrypted in all encryptable actuators of the Series 61, 62 and Series 71 as well as the FAM14. This requires the wireless encryption plug FVST. Encryptable actuators bear the pictogram .

Activate encryption:

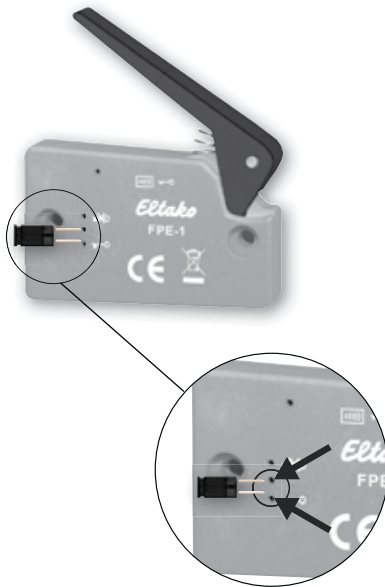

Insert the encryption plug and push the lever.

Deactivate encryption:



Insert the encryption plug and push the lever.



enocean®

THE UNIQUE WIRELESS PROFESSIONAL SMART HOME STANDARD

| | |
|----------------|------------|
| Frequency | 868.3 MHz |
| Transmit power | max. 10 mW |

Hereby, Eltako GmbH declares that the radio equipment type FPE-1 is in compliance with Directive 2014/53/EU.

The full text of the EU declaration of conformity is available at the following internet address: eltako.com

Must be kept for later use!

Eltako GmbH
D-70736 Fellbach
Technical Support English:
 +49 711 94350025
 technical-support@eltako.de
eltako.com

46/2020 Subject to change without notice.