



30 055 725 - 1



Wireless sensor without battery or wire

Wireless pushbutton in E-Design FIT55E-



Temperature at mounting location:
-20°C up to +50°C.

Storage temperature: -25°C up to +70°C.

Relative humidity:

annual average value <75%.

Wireless 1-way pushbutton in E-Design55, 80x80 mm external dimensions, internal frame dimensions 55x55 mm, 15 mm high. Generates the power for wireless telegrams itself when the button is pressed, therefore there is no connecting wire and no standby loss. With rocker. Smart Home sensor.

The scope of supply comprises the frame R1UE55, a rocker, an attachment frame, a mounting base, the wireless module and one adhesive foil.

Wireless pushbuttons with one rocker can send an analysable signal. Press the bottom of the rocker near the mark.

The mounting base can be screwed onto a flat surface or glued to the wall, on glass or on furniture using the enclosed adhesive foil. Use the sleeves in the 55 mm socket box for screw mounting.

Before screwing on the device, remove the rocker and remove the frame from the mounting plate. Then screw on the mounting base - with the 'top' marking pointing upwards. Snap the frame and rocker back in.

We recommend stainless-steel countersunk screws 2.9x25 mm, DIN 7982 C, for screw connections. Both with rawl plugs 5x25 mm and with 55 mm switch boxes.

If the FIT55E is to be integrated into multiple frames, the corners marked on the back of the multiple frames must be broken out, depending on the orientation.

The wireless module integrated in the wireless pushbutton can be taught-in encrypted as described in the operating instructions in all encryptable actuators of the Series 61, 62 and 71 as well as the FAM14. This requires the wireless encryption plug FVST.

Encryptable actuators bear the pictogram .

Teaching-in wireless sensors in wireless actuators

All sensors must be taught-in in the actuators so that they can detect and execute commands.

The teach-in process is described in the operation manual of the actuators.

Activate encryption:

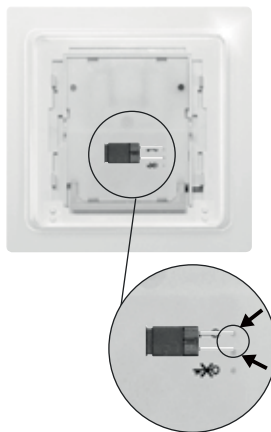

Insert the encryption plug and operate the rocker.

Deactivate encryption:

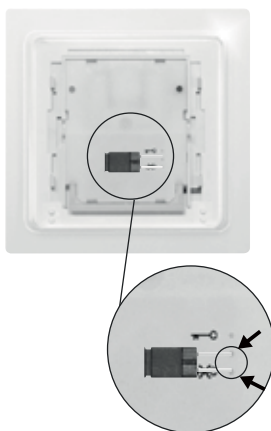

Insert the encryption plug and operate the rocker.

Manuals and Documents in further Languages



<http://eltako.com/redirect/FIT55E->

1.  App

2. 

3. [www.](#)



enocean®

THE UNIQUE WIRELESS **PROFESSIONAL**
SMART HOME STANDARD

Frequency 868.3 MHz

Transmit power max. 10 mW

Hereby, Eltako GmbH declares that the radio equipment type FIT55E- is in compliance with Directive 2014/53/EU.

The full text of the EU declaration of conformity can be accessed via the QR code or the internet address under 'Documents'.

Must be kept for later use!

Eltako GmbH

D-70736 Fellbach

Technical Support English:

 +49 711 943 500 25

 technical-support@eltako.de

eltako.com

21/2023 Subject to change without notice.